

VMC855 High Speed 5axis CNC Milling Machine with 24 ATC Max Table Load of 600kg

Our Product Introduction

Basic Information

- Place of Origin: China
- Brand Name: luyoung
- Model Number: vmc855
- Price: \$28,000.00/sets 1-1 sets
- Packaging Details:
 - 1.Non-fumigation packaging, we use seaworthy plywood.
 2. Steel base plate, it is stronger 3-5 times than normal plywood base plate.
 - 3.Water-proof and damp proof, water resistant film wrapped all the machine.
 - 4.Fully sheathed case,prevention of coll
- Supply Ability: 60 Set/Sets per Month



Product Specification

- Type: VERTICAL
- Range Of Spindle Speed(r.p.m): 50 - 8000
- Number Of Axes: 3
- Machining Capacity: Medium Duty
- Spindle Taper: BT40
- Table Travel (X) (mm): 800 Mm
- Table Travel (Y) (mm): 550 Mm
- Table Travel (Z) (mm): 550 Mm
- Positioning Accuracy (mm): 0.001
- Repeatability (X/Y/Z) (mm): 0.003
- Voltage: 220v/380v
- Dimension(L*W*H): 2700*2250*2700mm
- Key Selling Points: High-accuracy
- Weight (KG): 5000



More Images

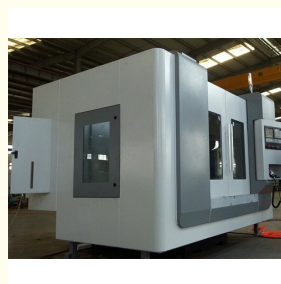

Product Description

VMC855 High Speed 5axis CNC Milling Machine with 24 ATC and Max. Table Load of 600 kg

VMC855 Vertical high speed metal 5axis cnc milling machine with 24 ATC

Product Description



vmc855 Vertical high

speed metal 5axis cnc milling machine with 24 ATC

🔥 This VMC is suitable for mechanical processing and mold making .And it can adapt to the processing requirement from rough machining to finish machining .It can also finish many working procedures like milling ,drilling ,tapping ,boring ,etc.Machining centers are usually classified according to the relative position of the spindle and the worktable, and are divided into horizontal, vertical and universal machining centers.

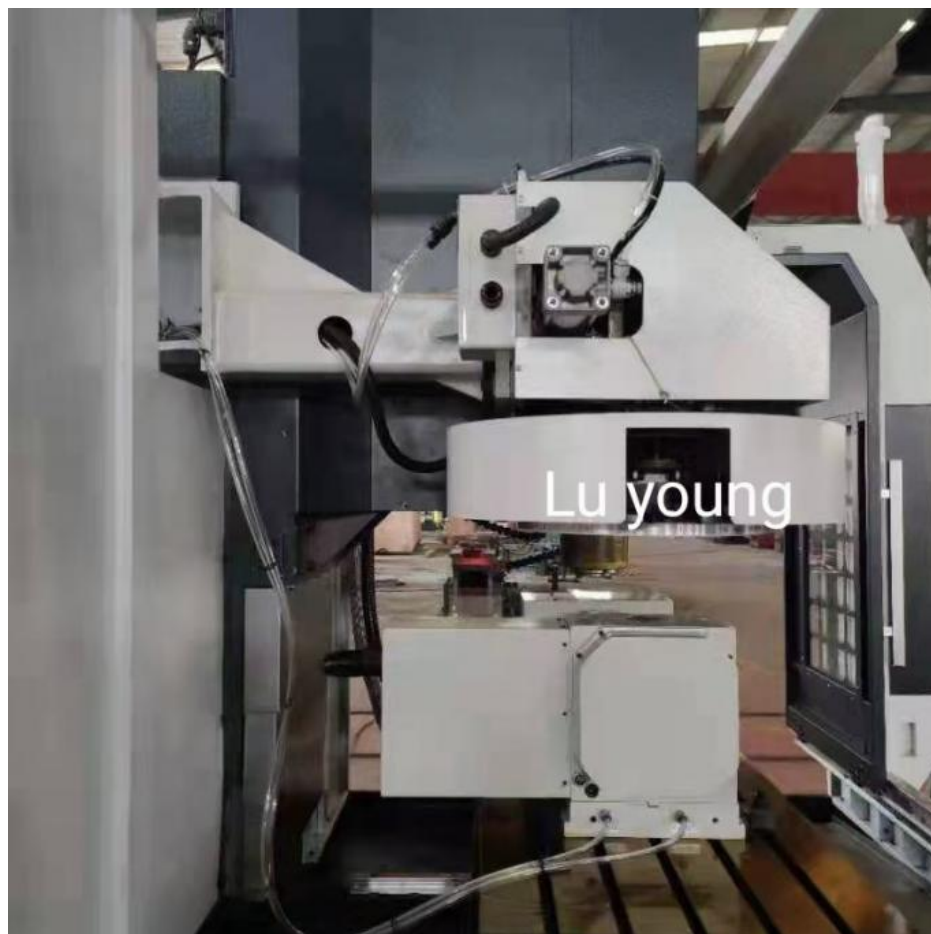

Specification

Item	VMC850
Size of worktable(length×width)mm	1000×500
T slot (mm)	5-18x100

Max loading weight on worktable	600kg
X-Axis travel(mm)	800
Y-Axis travel(mm)	500
Z-Axis travel(mm)	500
Distance between spindle nose and table	105-605mm
Distance between spindle center and column(mm)	550
Spindle taper	BT40-150
Max. spindle speed(rpm)	8000/10000/12000
Spindle motor power(Kw)	7.5/11kw
Rapid feeding speed: X,Y,Z axis m/min	16/16/16 (24/24//24 liner guidway)
Fast cutting speed m /min	10m/min
Positional accuracy	±0.005 mm
Repeat positional accuracy	±0.003 mm
Auto Tool changer type	16 tools head type tool changer(optional 24 arm type auto tool changer)
Max. tool length	300mm
Max. Tool diameter	Φ80(adjacent tool)/φ150(not adjacent tool)
Max.tool weight	8kg
Tool changing time(tool-to-tool)	7sec
Air pressure	0.6 Mpa
Machine weight	5500KG
Overall sizse(mm)	2600*2300*2300

TAIWAN SPINDLE

Famous Taiwan spindle.
High speed,high precision.
Good surface finishing.

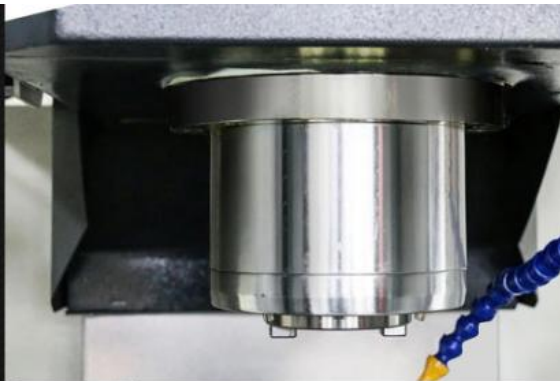

TAIWAN SCREW TAIWAN LINEAR RAIL

Taiwan screw&linear rails
High rigidity & accuracy.
Long service life



OPTICAL MACHINE

precision casting, precision machining.
Precision assembly.

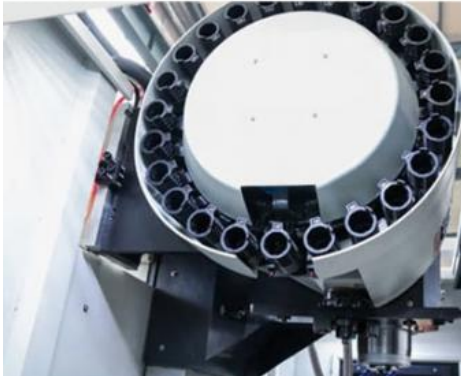

TAIWAN ATC

Standard with Taiwan 16 ATC type.
24 Arm ATC Can be choose as optional

CNC SYSTEM

CNC control system can be chosen. Like KND/GSK/Siemens/FANUC/Mitsubishi and other good system.



AUTO. LUBRICATION

Regular and quantitative auto. inter. lubrication.
Adjust lubrication time accordingly.

Product Features

What is the feature of our cnc milling machine with VMC855

- ◆ High quality resin sand
- ◆ Taiwan ball screw and locking nut
- ◆ Taiwan linear railway
- ◆ Automatic lubrication system
- ◆ Taiwan spindle
- ◆ Taiwan pressure cylinder
- ◆ Japanese NSK bearing Germany R+W coupling
- ◆ Chip conveyor at optional

Standard Configuration:

1. GSK25i CNC Controller.
3. 16 Auto Tool Changer.
5. Taiwan Hiwin ball screw.
7. Automatic Central Lubrication System.

Optional Configurations:

1. GSK KND Siemens Fanuc Mitsubishi.
2. Taiwan arm type ATC.
3. Automatic chip conveyor.
4. 4th axis and 5th axis
5. Spindle oil coolant, center to water.
6. Renishaw probe for workpiece and tool.

2. BT40 8000 rpm spindle unit.
4. Taiwan Hiwin linear guideway.
6. Work Lamp.
8. Full Enclosure Machine Guard.

01 Patching panel



VS



Our design is scientific and the appearance is neat

Some other company, the design is not scientific

02 Linear guide way



VS



We use Taiwan Hiwin linear guide way.

Other companies use other brands of linear guide way

03 Auto tool changer



Compact structure, short tool change time, low failure rate



The tool change time of other companies is long

04 spindle



The spindle has high operating accuracy and long-term accuracy and stability.



Other companies use ordinary spindles with low running accuracy and poor stability.

Advantage

- (1) Horizontal machining center: refers to the machining center with the spindle axis parallel to the worktable, which is mainly suitable for processing box parts.
- (2) Vertical machining center: refers to the machining center with the spindle axis perpendicular to the worktable. It is mainly suitable for processing complex parts such as plates, plates, molds and small shells.
- (3) Universal machining center (also known as multi-axis linkage machining center): refers to a machining center that can control and change the angle between the machining spindle axis and the rotation axis of the worktable to complete complex space surface processing. It is suitable for the processing of impeller rotors, molds, cutting tools and other workpieces with complex spatial curved surfaces.

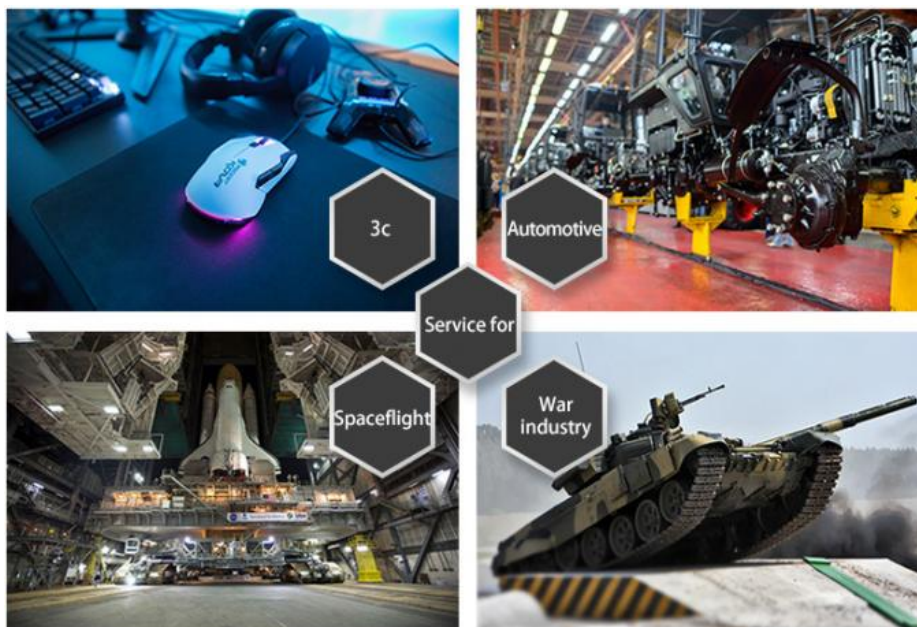

Our Services



01

365 days without false service, uninterrupted supply, pre-sales consultation, after-sales service and other technical support. We also offer free technical training and overseas services.

02

The warranty period of our products is one year. We provide 24-hour online technical service and contact us at any time.

- ♥ Training how to instal the machine, training how to use the machine.
- ♥ Engineers are available to service machinery overseas.
- ♥ Provide tools and accessories.
- ♥ Warranty is one year, we would offer the parts (quality problem) free of charge during this period.
- ♥ Note: GSK, Servo driven, motor and transformer, warranty is 3 years.

Company Information





Shandong luyoung machinery Co., Ltd. is a professional manufacturing enterprise engaged in the research, development, production, sale and service of CNC machines. Dedicated to strict quality control and thoughtful customer service, our experienced staff members are always available to discuss your requirements and ensure full customer satisfaction.

Our main products are Wheel Repair CNC Lathe Machine, Vertical CNC Lathe Machine, Horizontal CNC Lathe Machine, Slant Bed CNC Lathe Machine, Universal Lathe Machine, CNC Milling Machine and CNC Vertical Machining center. All the above products have passed CE, SGS certificates.



Customer visiting





1. Our customers come from more than 40 different countries and promote the most suitable products for different countries to provide the best service;
- 2 we participated in many exhibitions, the Chinese machinery exhibition, guangzhou commodities fair, through the exhibition to expand overseas market, we invite customers to visit our factory, also can be customized according to customer demand, through our products and services for customers

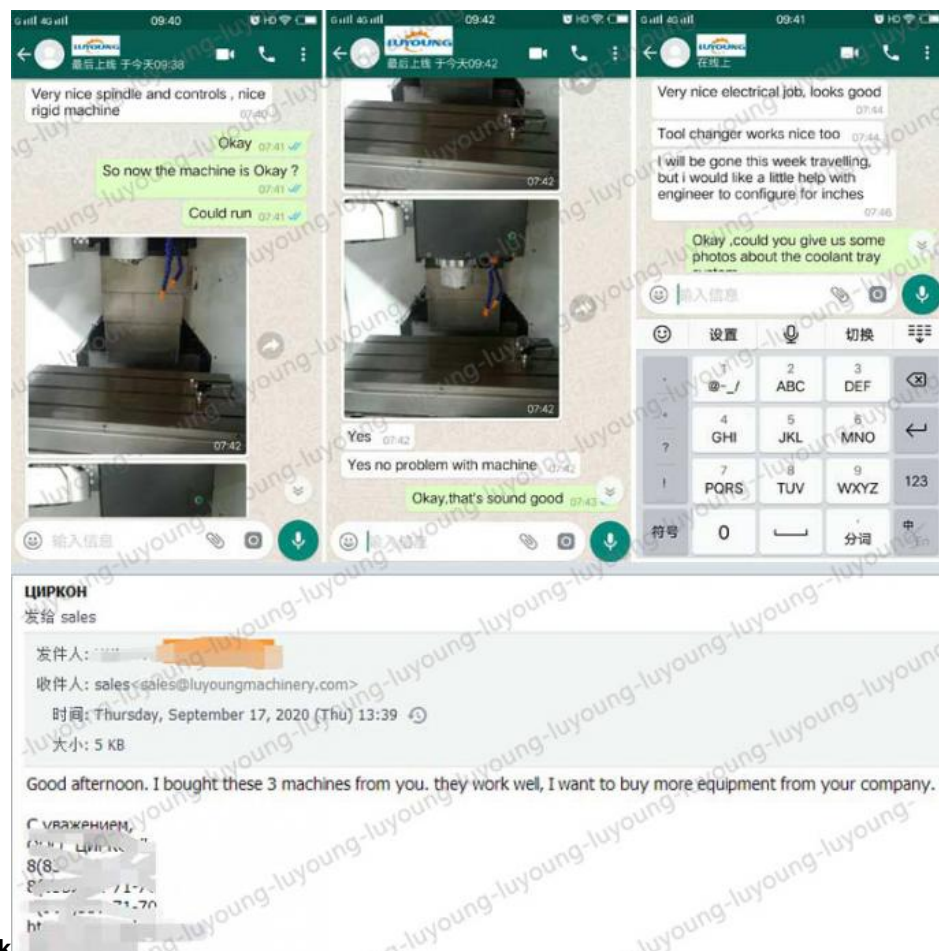

Customer feedback

FAQ

1:How can I choose the most suitable machines ?

A: Please tell me your specifications ,we can choose the best model for you , or you can choose the exact model . You can also send us the products drawing ,we will choose the most suitable machines for you .

2: What's your main products of your company?

A: We specialized in all kinds of machines ,such as CNC Lathe Machine ,CNC Milling Machine ,Vertical Machining Center ,Lathe Machines ,MANUAL lathe Machine,Sawing Machine ,Shaper machine and so on .

3: Where is our factory located? How can I visit there?

A : Our factory is located in Tengzhou City ,Shandong Province, China. You are warmly welcomed to visit us.

4. What is your trade terms?

A : FOB, CFR and CIF all acceptable.

5: What's the Payment Terms ?

A : T/T ,30% initial payment when order ,70% balance payment before shipment ;
Irrevocable LC at sight .

5: What's the MOQ?

A: 1 set .(Only some low cost machines will be more than 1 set)



shandong lu young machinery co.,ltd



86 18660852746



sales@luyoungmachinery.com



luyoungcncmachines.com

Room 1061, Building A, Guoshan Center, Taiqian Street, Taishan District, Taian City, Shandong Province